

ophelis deem

Agile working



Agility requires free space

Agile teams are the answer to the evolving dynamics and complexity of working life, triggered by digital change and the pressure to innovate. This kind of lean, effective way of working focusing on customer benefit is intended to ensure the success of the company in the future.

Agile transformation means far more than just gaining in flexibility and speed. It represents a new way of organising work at all levels of the business. Increasingly, fixed structures, formal hierarchies and traditional departments are being replaced by dynamic networks, where the skills and needs of each individual employee are recognised. Agile businesses bring people together and empower them to work on projects and search for solutions collaboratively, independently and quickly. In agile teams, people involved in projects become real partners.

Agile and creative work demands short pathways and continuous, intense development within teams. Agile teams take their work environment into their own hands and organise it as their work demands. However, doing this demands the tools and spaces that promote exactly this type of project work and new flexibility. ophelis deem was developed for this.

ophelis deem

ophelis deem is a range of work furniture that supports agile and creative collaboration. The complementary pieces of this ensemble include a podium, mobile presentation boards, mobile tables and benches, as well as a multi-functional room partitioning system.

ophelis deem was designed by Till Grosch in cooperation with ophelis.

Agile teams communicate on the same level rather than hierarchically. Work and interaction no longer take place in typical work and meeting rooms, but in project rooms and meeting points. ophelis deem embodies the mobility of agile teams and enables there to be spontaneous changes of tasks and roles at any time.

The wide range of colours and materials of the surfaces in melamine, lacquer and veneer as well as the textile collections contribute to the creative character of rooms and areas for project and team work.

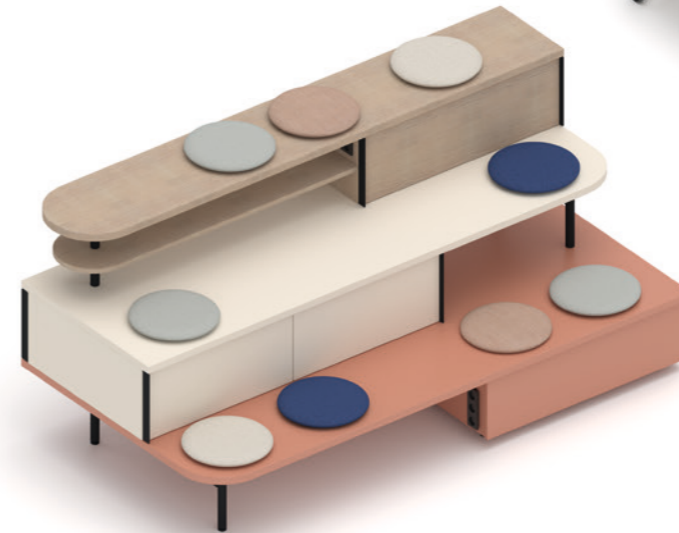
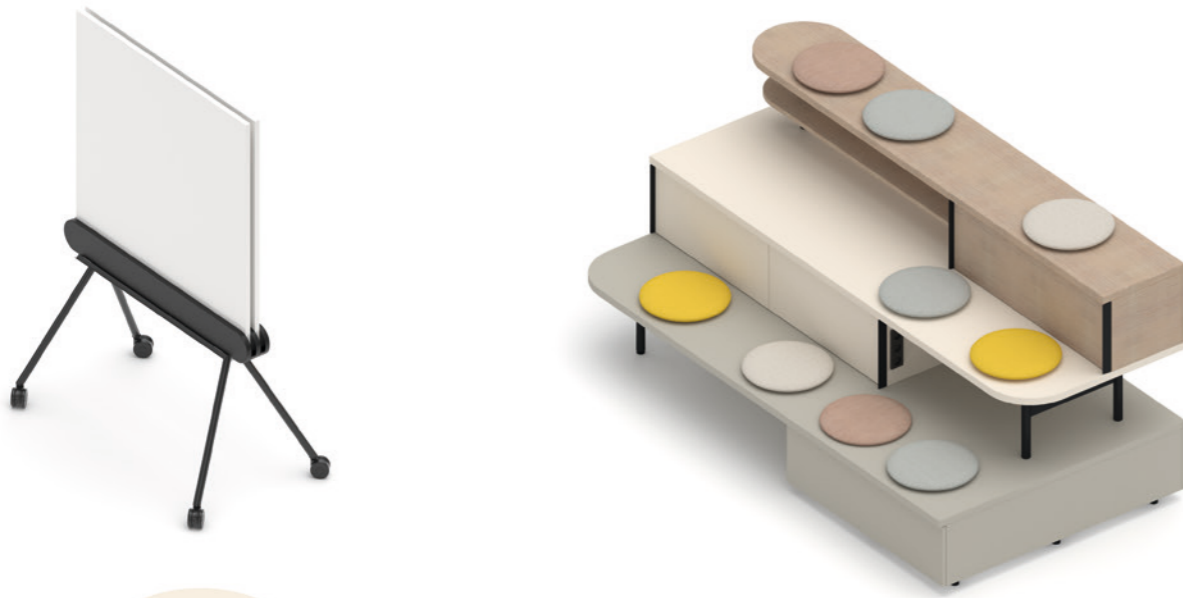

"deem is highly flexible and so invites you to playfully deal with the various elements. The castors and light weight make it easy to position tables, seats and boards as required."

Till Grosch, Designer, Studio Grosch, Berlin





Agile working means largely dispensing with centrally defined standards and processes – project rooms support the development of a team-based, decentralised networked structure.

deem tables



deem tables and benches are all mounted on castors, which make them highly mobile. Standing and sitting tables are optionally equipped with centrally braked castors, which ensure comfortable handling with maximum mobility. Electric tables have a desktop connection panel for convenient access to data and power, as well as a self-retractable cable reel on the underside of the table. This means that the tables can be used flexibly. The oval table shape promotes close discussion.

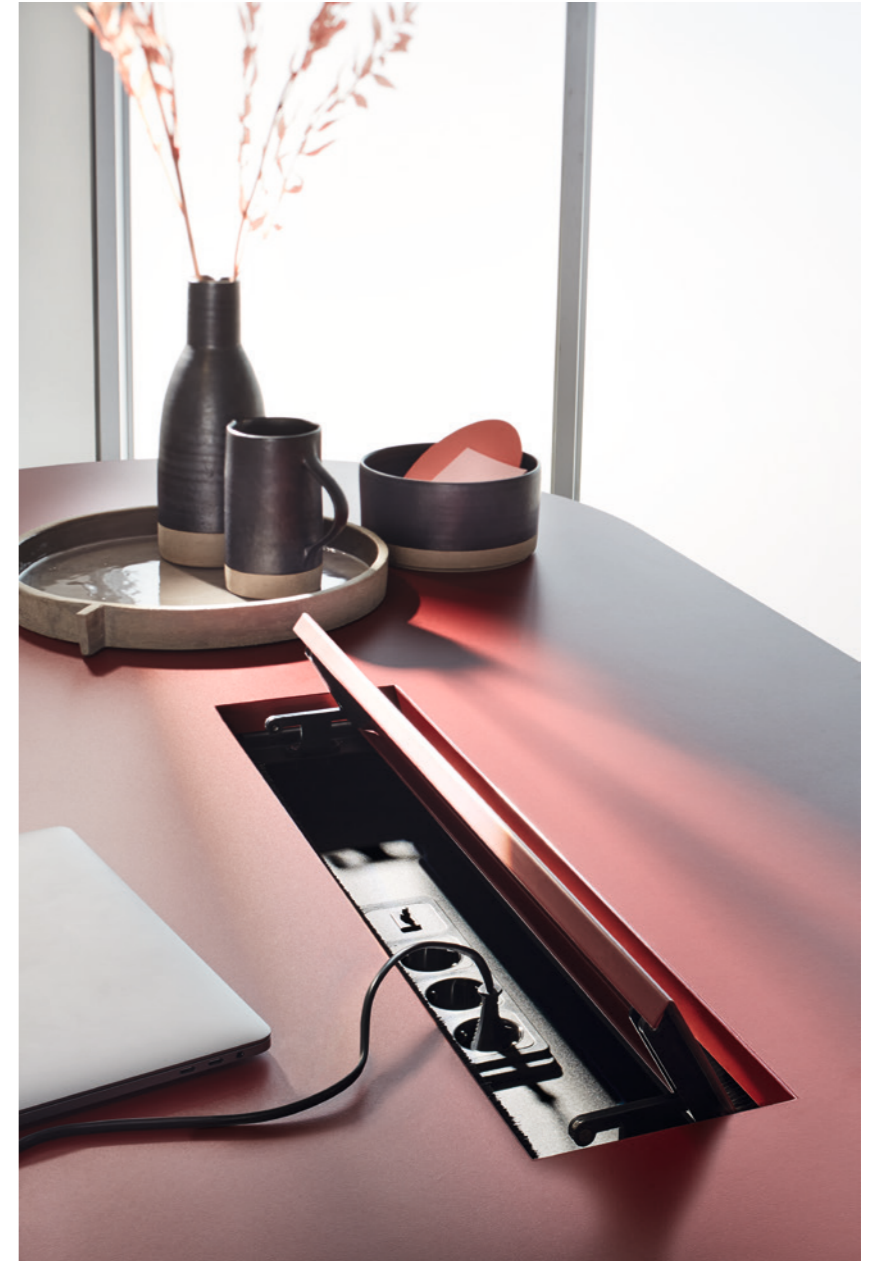

Details make all the difference: Convenient, two-way access to the power supply via the ophelis Userbase.

The self-retractable cable reel ensures easy handling and maximum flexibility of furniture with electrical connections.

Operating the central roller brake via the lever beneath the table top.





Ongoing feedback processes and personal communication are very important in agile companies. From the very start, the team is involved in all decisions.

deem arena



deem arena is both a place to sit and a meeting point for stand-up meetings, as well as a work surface and storage space – a hybrid piece of furniture with an electricity supply which acts as a central point for exchange and presentations. This youthful item of furniture deliberately plays with alternative working postures and promotes cooperative discussion. Each module accommodates up to nine people. Seat cushions provide comfortable seating, and they can easily be stowed away in the storage space after meetings.



The electrically connected modules are equipped with power and USB charging points. deem arena is modular: free-standing in the space or wall-mounted, stand-alone or in any length with add-on modules. Unlike fixed podiums, deem arena is a system furniture concept that provides greater flexibility for the company.



Greater transparency, personal responsibility and co-determination:
Agile teams need as much freedom as possible to achieve their
objectives – the same is true for the design of the working environment.

deem benches



deem benches offer complete flexibility and playful use of seating. The benches can be easily rearranged using the castors mounted on one side, allowing them to be repositioned according to the situation and team size, in any configuration.



deem memo and memo wall



Analogue graphs and processes are an important component of agile project work. Boards are a central meeting place for agile teams and the centre of information exchange. deem memo is a mobile presentation surface. Usable as a whiteboard, projection screen or magnetic board, deem memo assists with visualisations. The lightweight whiteboards can be taken out to be freely positioned in the room to use them on deem meta or in combination with memo wall on the walls of the room. The removable whiteboards measure 1,200 × 1,200 mm.





Working dynamically in cross-functional teams requires demarcated areas in open floor plans with opportunities for quick coordination and team meetings.



Rest area in a dynamic working environment: The stable components represent a solid, agile mission statement and an appreciative, trusting corporate culture.

deem meta



A homely and eye-catching design element: Melamine, lacquered or veneered surfaces in combination with the material range of the textile collection offer plenty of scope for interior design.



A structuring, space-forming piece of furniture, deem meta is a central point for teamwork in open office landscapes. The homely-looking system is acoustically effective, serving as a presentation surface and wardrobe. Depending on requirements, shelves, seating or plant tubs can be combined as needed. deem meta is designed for use in group offices and, as a central team meeting point, supports communication for agile and mobile working. The removable magnetic and writable whiteboards are compatible with memo and memo wall.





Frequent and high-quality communication fosters the open exchange of knowledge both within a team and across departmental and team boundaries.



Spaces for open exchange: Open communication and the inclusion of all participants in the corporate goals are central elements of agile work and foster employee commitment.

ophelis deem

arena

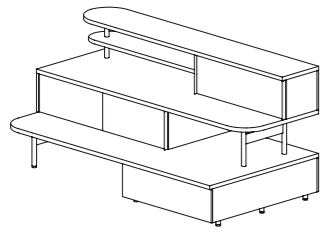

arena base module

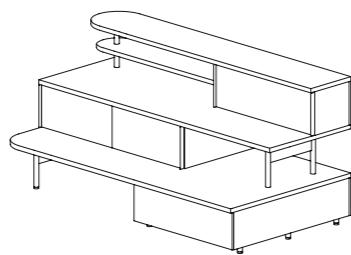

arena intermediate module

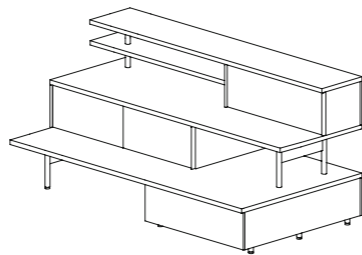

arena end module

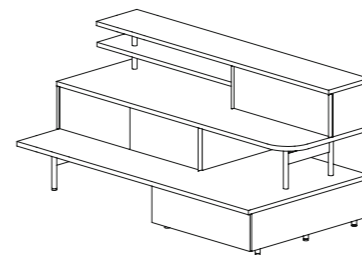

Widths: 2,100 and 2,600 mm
Depth: 1,350 mm
Height: 1,210 mm

meta planting bowl

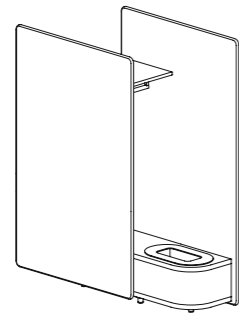
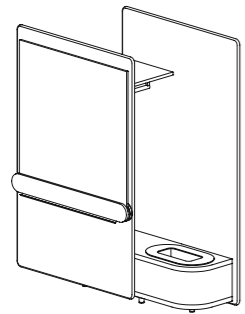

meta shelf

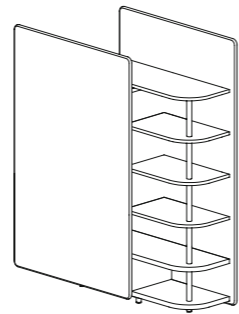
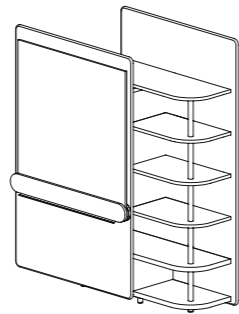

meta bench seat

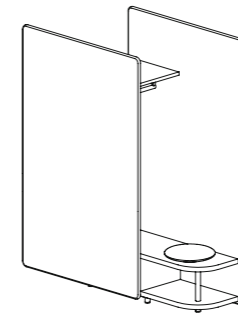
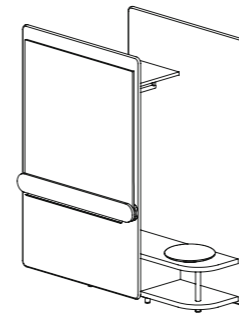

Width: 2,000 mm
Depth: 500 mm
Height: 2,200 mm
Whiteboard: 1,200 x 1,200 mm

deem table
without power supply

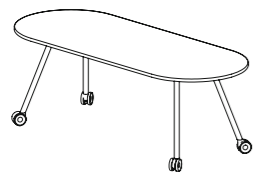

deem table
with power supply

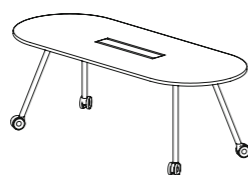

Sizes: 1,800 x 800 mm /
2,250 x 900 mm
Height: 720 mm

deem high table
without power supply



deem high table
with power supply



Sizes: 1,800 x 900 mm /
2,250 x 900 mm
Height: 1,050 mm

memo

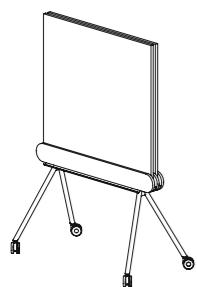

Width: 1,367 mm
Depth: 792 mm
Base height: 850 mm
Total height incl.
whiteboard: 1,950 mm

memo wall

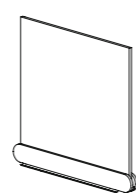

Width: 1,280 mm
Depth: 93 mm
Whiteboard:
1,200 x 1,200 mm

deem benches

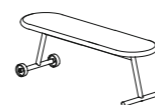

Widths: 1,200, 1,500
and 1,800 mm
Depth: 400 mm
Seat height: 450 mm

Seat cushions



Diameter: 400 mm

Glossary

Title page

- arena
 - Lower level
 - Melamine grey green
 - Cushions: kvadrat Star 2 (787), kvadrat Umami 221 (l.t.r.)
 - Mid-level
 - Melamine cream white
 - Cushions: kvadrat Remix 3 (612), kvadrat Star 2 (787), kvadrat Field 2 (222) (l.t.r.)
 - Upper level
 - Whitewashed oak veneer
 - Cushions: kvadrat Tonus 4 (610)

- memo
 - Whiteboard mounting: Melamine silk grey
 - Frame: Silk grey
 - Pen tray: Silk grey

- Table
 - Tabletop: Whitewashed oak veneer
 - Userbase: Whitewashed oak veneer
 - Frame: Cream white
- Bench 150
 - kvadrat Remix 3 (653)
 - Frame: Cream white
- High table
 - Tabletop and shelf: Melamine grey green
 - Frame: Graphite black
- Rug
 - kvadrat Kanon 0003

Page 6/7

- High table
 - Tabletop and shelf: Melamine cream yellow
 - Userbase: Cream white
- Frame: Cream white
- Panel: Cream white
- Bench 150
 - kvadrat Hallingdal 65 (103)
 - Frame: Cream white
- Bench 120
 - Camira Blazer Sheffield CUZ1T
 - Frame: Cream white
- Bench 120
 - kvadrat Umami (221)
 - Frame: Cream white
- Bench 180
 - kvadrat Field 2 (463)
 - Frame: Cream white

- memo
 - Whiteboard mounting: Melamine silk grey
 - Frame: Silk grey
 - Pen tray: Silk grey
- Curtains
 - kvadrat Rocket 181
- Lights
 - Louis Poulsen Flindt white wall lamp Ø 30cm

Page 8/9

- High table
 - Tabletop and shelf: Melamine wine red
 - Userbase: Wine red
 - Frame: Beige red
 - Panel: Beige red

- Table
 - Tabletop: Whitewashed oak veneer
 - Userbase: Whitewashed oak veneer
 - Frame: Cream white

Page 10/11

- arena
 - Lower level
 - Melamine grey green
 - Cushions: kvadrat Tonus Meadow (115), kvadrat Steelcut Trio 3 (213), kvadrat Hallingdal 65 (103) (l.t.r.)
 - Mid-level
 - Melamine cream white
 - Cushions: kvadrat Steelcut Trio 3 (446)
 - Upper level
 - Whitewashed oak veneer
 - Cushions: kvadrat Steelcut Trio 3 (446), kvadrat Fiord (721), kvadrat Umami (221) (l.t.r.)

- Bench 150
 - kvadrat Hallingdal 65 (103)
 - Frame: Cream white
- memo
 - Whiteboard mounting: Melamine silk grey
 - Frame: Silk grey
 - Pen tray: Silk grey
- High table
 - Tabletop and shelf: Silk grey lacquer
 - Userbase: Silk grey
 - Frame: Silk Grey
 - Panel: Silk grey
- Coat stands
 - Mobles 114 – Taiga Stand

Page 12

- arena
 - Lower level
 - Melamine grey green
 - Cushions: kvadrat Umami (221), kvadrat Rime (231) (l.t.r.)
 - Mid-level
 - Melamine cream white
 - Cushions: kvadrat Steelcut Trio 3 (446), kvadrat Tonus Meadow (115) (l.t.r.)
 - Upper level
 - Whitewashed oak veneer
 - Cushions: kvadrat Fiord (721)

Page 13

- arena
 - Lower level
 - Melamine grey green
 - Cushions: kvadrat Rime (231)
 - Mid-level
 - Melamine cream white
 - Cushions: kvadrat Steelcut Trio 3 (446), kvadrat Umami (221) (l.t.r.)
 - Upper level
 - Whitewashed oak veneer
 - Cushions: kvadrat Fiord (721), kvadrat Hallingdal 65 (103), kvadrat Steelcut Trio 3 (446), kvadrat Umami (221) (l.t.r.)

Page 14/15

- Desk
 - Tabletop: Whitewashed oak veneer
 - Userbase: Whitewashed oak veneer
 - Frame: Cream white

- Bench 150
 - Kvadrat Remix 3 (653)
 - Frame: Cream white
- Bench 150
 - Kvadrat Umami (441)
 - Frame: Cream white
- memo wall with whiteboard
 - Melamine wine red
 - Pen tray: Graphite black
- Lights
 - Louis Poulsen Above, Ø 17.5 cm, white
- Curtains
 - Camira Blazer Silverdale (CUZ28)
- Rug
 - kvadrat Grano (0231)

Page 16/17

- Bench 120
 - kvadrat Field 2 (142)
 - Frame: Graphite black
- Bench 150
 - kvadrat Coda 2 (962)
 - Frame: Graphite black
- Bench 180
 - Field 2 (463)
 - Frame: Cream white
- memo
 - Whiteboard mounting: Melamine silk grey
 - Frame: Silk grey
 - Pen tray: Silk grey
- memo
 - Whiteboard mounting: Melamine graphite
 - Frame: Graphite black
 - Pen tray: Graphite black
- memo wall
 - Whiteboard mounting: Melamine wine red
 - Pen tray graphite black

Page 18/19

- High table
 - Tabletop and shelf: Melamine wine red
 - Userbase: Wine red
 - Frame: Beige red
 - Panel: Beige red
- meta
 - Small wall: kvadrat Coda 2 (116)
 - Large wall: kvadrat Hint (347)
 - Surfaces: Whitewashed oiled oak veneer
 - Whiteboard mounting: Whitewashed oiled oak
 - Pen tray: Graphite black
- sum single seater
 - Upholstered section: kvadrat Field 2 (643)
 - Cushions: kvadrat Divina Melange 3 (227)
 - Folding screen: kvadrat Divina Melange 3 (227)
 - Frame: Beige red
- sum two-seater
 - Upholstered section: kvadrat Field 2 (693)
 - Cushions: kvadrat Field 2 (663)
 - Folding screen: kvadrat Tonus 4 (610)
 - Frame: Wine red

- sum three-seater
 - Upholstered section: kvadrat Field 2 (693)
 - Small cushion kvadrat Field 2 (663)
 - Large cushion kvadrat Field 2 (643)
 - Folding screen: kvadrat Tonus 4 (610)
 - Frame: Wine red
- Add on floor
 - Tabletop: Painted wine red
 - Frame: Wine red
- Side table
 - Tabletop: Painted wine red
 - Frame: Wine red
- Lights
 - Foscarini Twiggy lettura, white floor lamp
- Rug
 - kvadrat Kelim Pattern Resort (0013)
- Curtains
 - kvadrat Rocket (621)

Page 20/21

- docks
 - Upholstered section, 135 × 90 back-rest on the right: Camira Mainline Flax MLF16
 - Upholstered section corner module 90 × 90: kvadrat Steelcut Trio 3 (276)
 - Upholstered section 90 × 90, back-rest on the left: kvadrat Field 2 (373)
 - Side legs: Graphite black
 - Bricks: Black oak veneer
 - Corner folding screen: kvadrat Coda 2 (382)
 - Cushions: kvadrat Coda 2 (382)
- docks stool
 - Coda 2 (382)
 - Frame: Graphite black
- meta
 - Left wall: kvadrat Divina Melange 3 (260)
 - Right wall: kvadrat Fiord (271)
 - Surfaces: Melamine grey brown
 - Cushions: kvadrat Coda 2 (382)
- docks table
 - Tabletop: Walnut veneer, oiled
 - Side legs: Solid walnut, oiled
- Zeitraum Plaisir 1
 - Oak, dark warm grey stain
- Zeitraum Plaisir 2
 - Oak, dark warm grey stain
- Rug
 - Object Carpet Glamour 2404
- Curtain
 - kvadrat Relax 0011
- Lights
 - Foscarini Twiggy, gooseneck lamp, black
- Zeitraum Okito
 - Black oak

Page 22

- deem meta
 - Small wall: kvadrat Coda 2 (116)
 - Large wall: kvadrat Fiord (347)
 - Surfaces: Whitewashed oiled oak veneer
 - Whiteboard mounting: Whitewashed oiled oak
 - Pen tray: Graphite black
 - Cushions: kvadrat Remix 3 (612)

Page 23

- deem meta
 - Small wall: kvadrat Divina Melange 3 (260)
 - Large wall: kvadrat Fiord (271)
 - Whiteboard mounting: Melamine grey brown
 - Pen tray: Graphite black
 - Surfaces: Melamine grey brown
 - Cushion: kvadrat Coda 2 (382)

Page 24/25

- arena
 - Lower level
 - Melamine black blue
 - Cushion: Camira Blazer Edinburgh (CUZ1Y), kvadrat Star 2 (787) (l.t.r.)
 - Mid-level
 - Melamine black blue
 - Cushion: kvadrat Field 2 (782), Camira Blazer Edinburgh (CUZ1Y), kvadrat Star 2 (787) (l.t.r.)
 - Upper level
 - Melamine black blue
- Bench 120
 - kvadrat Umami (111)
 - Frame: Cream white
- Bench 120
 - kvadrat Field 2 (142)
 - Frame: Graphite black
- Bench 120
 - kvadrat Hallingdal 65 (166)
 - Frame: Cream white
- memo
 - Whiteboard mounting: Melamine graphite
 - Frame: Graphite black
 - Pen tray: Graphite black
- Zeitraum Okito Bar
 - Black oak
- Lights
 - Projecteur 165 Pincer Clip midnight blue
- Rug
 - kvadrat Bliss (2215)

Page 26/27

- arena base module
 - Lower level
 - Melamine grey green
 - Cushions: kvadrat Tonus Meadow (115), kvadrat Hallingdal 65 (103) (l.t.r.)
 - Mid-level
 - Melamine cream white
 - Cushions: kvadrat Rime (231), kvadrat Fiord (721) (l.t.r.)
 - Upper level
 - Whitewashed oak veneer
 - Cushions: kvadrat Hallingdal 65 (103), kvadrat Tonus Meadow (115) (l.t.r.)
- arena right mount
 - Lower level
 - Melamine silk grey
 - Cushions: kvadrat Steelcut Trio 3 (446), kvadrat Umami (111) (l.t.r.)
 - Mid-level
 - Melamine cream white
 - Cushions: kvadrat Steelcut Trio 3 (446), kvadrat Fiord (271) (l.t.r.)
 - Upper level
 - Melamine cream white
 - Cushions: kvadrat Steelcut Trio 3 (446), kvadrat Field 2 (222) (l.t.r.)
 - Mid-level
 - Melamine cream white
 - Cushions: kvadrat Steelcut Trio 3 (213) (l.t.r.)
 - Upper level
 - Whitewashed oak veneer
 - Cushions: kvadrat Field 2 (222), kvadrat Steelcut Trio 3 (446) (l.t.r.)

- Upper level
 - Whitewashed oak veneer
 - Cushions: kvadrat Fiord (101), kvadrat Fiord (721), kvadrat Steelcut Trio 3 (446) (l.t.r.)

- Table
 - Tabletop: Melamine cream white
 - Frame: Cream white

- Bench 150
 - kvadrat Coda 2 (962)
 - Frame: Silk grey

- Bench 150
 - kvadrat Steelcut Trio 3 (446)
 - Frame: Cream white
- Table
 - Tabletop: Melamine silk grey
 - Frame: Silk grey

- Bench 180
 - kvadrat Field 2 (463)

- High table
 - Melamine surfaces, grey green
 - Frame: Graphite black

- Zeitraum Okito
 - Black oak
- Zeitraum Okito Stool
 - Black oak
- Zeitraum Okito Bar
 - Black oak

- Lights
 - Louis Poulsen Cirque pendant light, copper
 - Louis Poulsen Cirque pendant light, yellow

- Rug
 - kvadrat Twist 0011

Page 29

- arena base module
 - Lower level
 - Melamine grey green
 - Cushions: kvadrat Tonus Meadow (115), kvadrat Field 2 (222), kvadrat Rime (231) (l.t.r.)
 - Mid-level
 - Melamine cream white
 - Cushions: kvadrat Fiord (721), kvadrat Steelcut Trio 3 (446) (l.t.r.)
 - Upper level
 - Whitewashed oak veneer
 - Cushions: kvadrat Hallingdal 65 (103), kvadrat Field 2 (222), kvadrat Fiord (721), kvadrat Umami (221), kvadrat Umami (111) (l.t.r.)

- arena right mount
 - Lower level
 - Melamine silk grey
 - Cushions: kvadrat Steelcut Trio 3 (446), kvadrat Umami (111) (l.t.r.)

- Mid-level
 - Melamine cream white
 - Cushions: kvadrat Steelcut Trio 3 (446), kvadrat Steelcut Trio 3 (213) (l.t.r.)
- Upper level
 - Whitewashed oak veneer
 - Cushions: kvadrat Field 2 (222), kvadrat Steelcut Trio 3 (446) (l.t.r.)

ophelis GmbH

Dr.-Alfred-Weckesser-Straße 1 D-76669 Bad Schönborn
Telephone: +49(0)72 53.83-0 Fax: +49(0)72 53.83-100
www.ophelis.de info@ophelis.de

08/2019

